

Solenoid Valve YT-700 Series

Product Number: YT-700 (specify your requirement)

Model	Valve Type	Connection Type	Power Source	Pressure
YT-700	S 3way	P PT 1/4	1 AC 110V	1 0 ~ 4kgf/cm ² (3way)
	D 4way	N NPT 1/4	2 AC 220V	2 0 ~ 7kgf/cm ² (3way)
			3 DC 24V	3 1.0~10kgf/cm ² (4way)

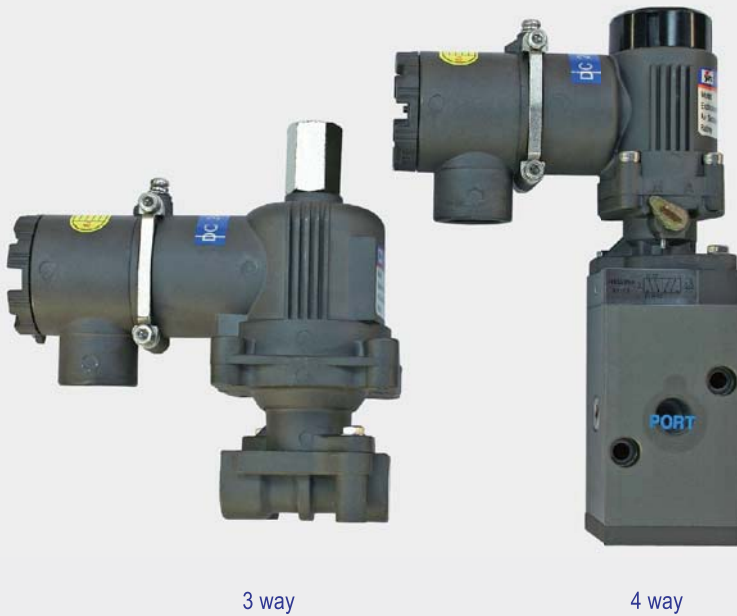

3 way

4 way

Item · Type	YT-700	
	3 way	4 way
Max. Supply Pressure	0 ~ 4kgf/cm ² 0 ~ 7kgf/cm ²	1.0~10kgf/cm ²
Flow Capacity (Cv)	Output	0.2(φ3)at 4kgf/cm ² 0.084(φ1.6)at 7kgf/cm ²
	Exhaust	0.093
Rating Current	AC 110V	160mA
	AC 220V	100mA
	DC 24V	290mA
Explosion Proof type	Exd IIC T6	
Connection Type	PT (NPT) 1/4	
Conduit	PF 1/2 (G1/2)	
Coil Insulation Grade	Class B	
Ambient Temp.	Standard	-20~70 °C (-4~158 °F)
	Explosion	-20~50 °C (-4~122 °F)
Weight	0.8kg(1.8lb)	0.9kg(2.0lb)

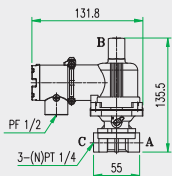

YT-700S (3WAY)

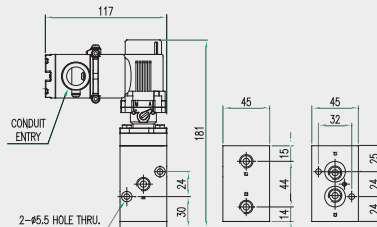

YT-700D (4WAY)

Solenoid valve YT-700 opens and shuts by electrical signal of AC or DC, It is built as explosion-proof structure.

- O-ring shapes: less lubrication required
- Balance spool type: no require of backing spring
- Interchangeable of AC and DC coils
- Manual override switch